

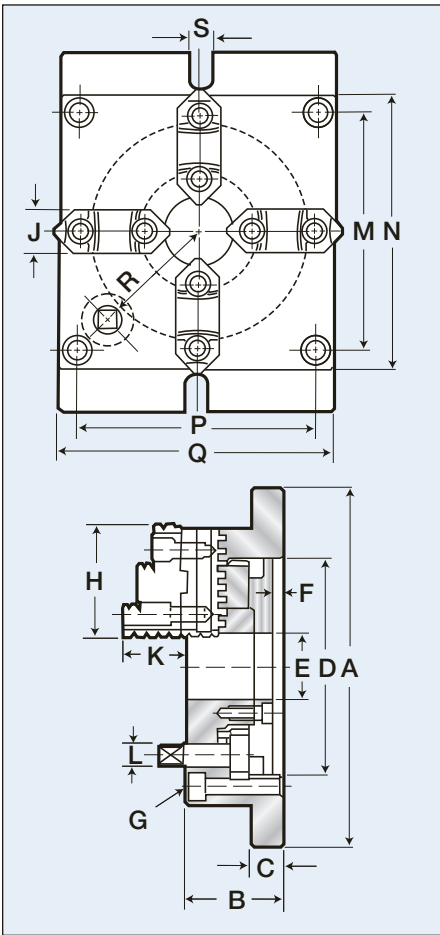

# Atlas Workholding Super Thin Square Chucks

## Series MCA

- Ⓜ Universal scroll chuck design
- Ⓜ End-surface clamping design enables fast efficient mounting of several chucks to a worktable
- Ⓜ Super thin design allows greater Z-axis machining
- Ⓜ Elongated slots allows fast and easy positioning on worktable, simply use standard T-bolts, versus mounting connecting plates required by conventional chucks
- Ⓜ Milled key-slots on the base plate allows accurate quick changing of the chucks
- Ⓜ Ideal for pallet applications, Standard Mills, Vertical Machining Centers, Angle Plates, Tombstones, and Grinding Machines.
- Ⓜ American standard, hard top and master jaws
- Ⓜ One year warranty



Model	Approx Weight	Gripping capacity			
		External Min.	External Max.	Internal Min.	Internal Max.
MCA6	25 lbs	.16"	5.04"	2.17"	5.04"
MCA8	41 lbs	.20"	6.38"	2.44"	6.34"
MCA10	70 lbs	.24"	7.78"	2.83"	7.78"
MCA12	125 lbs	.39 "	10.43"	3.54 "	10.43"

### Dimensional Data (in inch)

Model	A	B	C	D	E	F	G	H	J	K	L	M	N	P	Q	R	S
MCA6	8.46	2.24	.71	5.12	1.57	.22	4-M10x1.5P	2.68	1.02	1.54	.551*	5.67	6.50	5.67	6.50	2.60	.71
MCA8	9.84	2.56	.79	6.30	2.17	.24	4-M12x1.7P	3.23	1.10	1.69	.669*	6.85	7.87	6.85	7.87	3.27	.71
MCA10	12.20	2.83	.87	7.87	2.76	.24	4-M14x2P	3.66	1.26	1.97	.827*	8.58	9.84	8.58	9.84	4.09	.71
MCA12	14.96	3.35	.98	10.24	3.94	.27	4-M16x2P	4.64	1.57	2.20	.905*	10.79	12.20	10.79	12.20	5.31	.87

\*square drive

HOW TO ORDER: State quantity, Model Number of chuck and shipping instructions.